

Soils Map

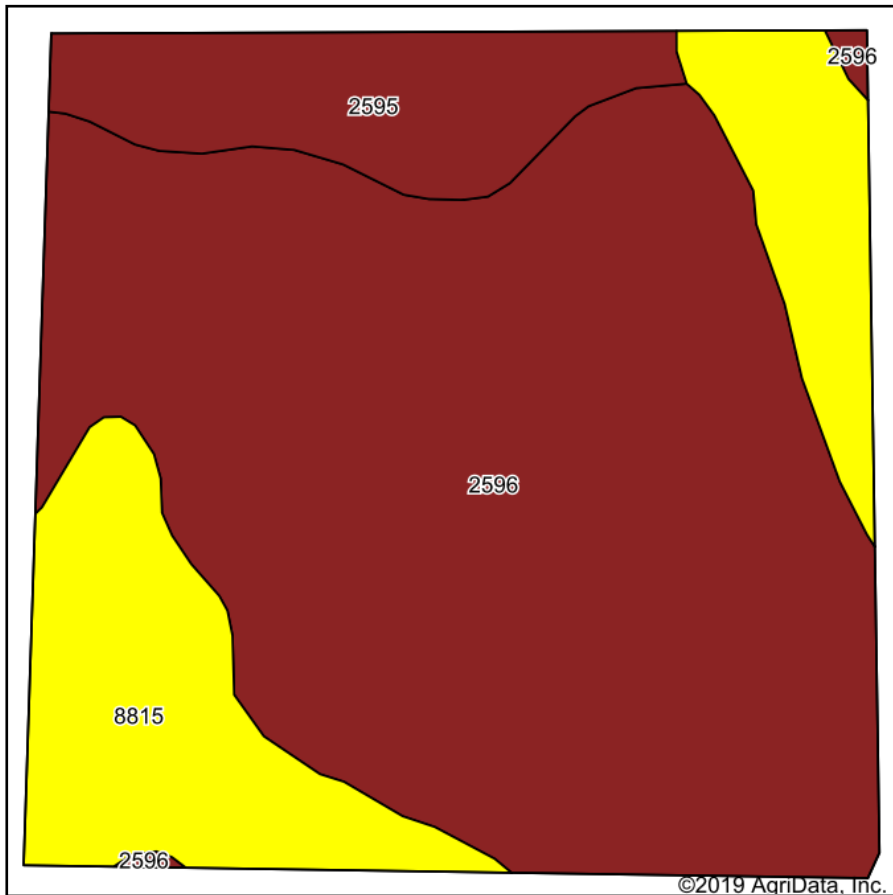

Soils data provided by USDA and NRCS.

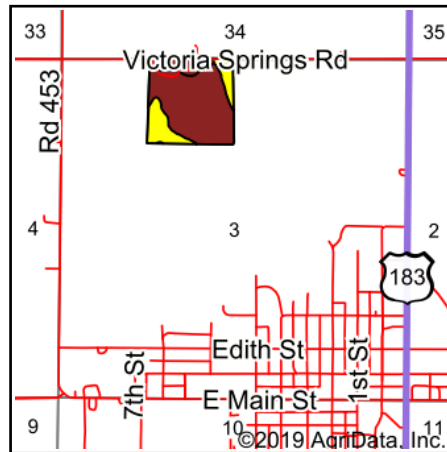

State: **Nebraska**
 County: **Custer**
 Location: **3-19N-18W**
 Township: **Sargent**
 Acres: **38.65**
 Date: **1/8/2020**

Maps Provided By:



Area Symbol: NE041. Soil Area Version: 18													
Code	Soil Description	Acres	Percent of field	Non-Irr Class Legend	Non-Irr Class *c	Irr Class *c	SRPG	Alfalfa hay Irrigated	Corn	Corn Irrigated	Grain sorghum	Grain sorghum Irrigated	*n NCCPI Soybeans
2596	Hersh fine sandy loam, 3 to 6 percent slopes	26.68	69.0%		IIIe	IIIe	56	1	3	16	4	8	46
8815	Cozad silt loam, 0 to 1 percent slopes	7.94	20.5%		IIc	Iw	67						68
2595	Hersh fine sandy loam, 0 to 3 percent slopes	4.03	10.4%		IIIe	IIIe	59	1	4	17	5	11	46
Weighted Average							58.6	0.8	2.5	12.8	3.3	6.7	*n 50.5

*n: The aggregation method is "Weighted Average using major components"

*c: Using Capabilities Class Dominant Condition Aggregation Method

Soils data provided by USDA and NRCS.