

Soils Map

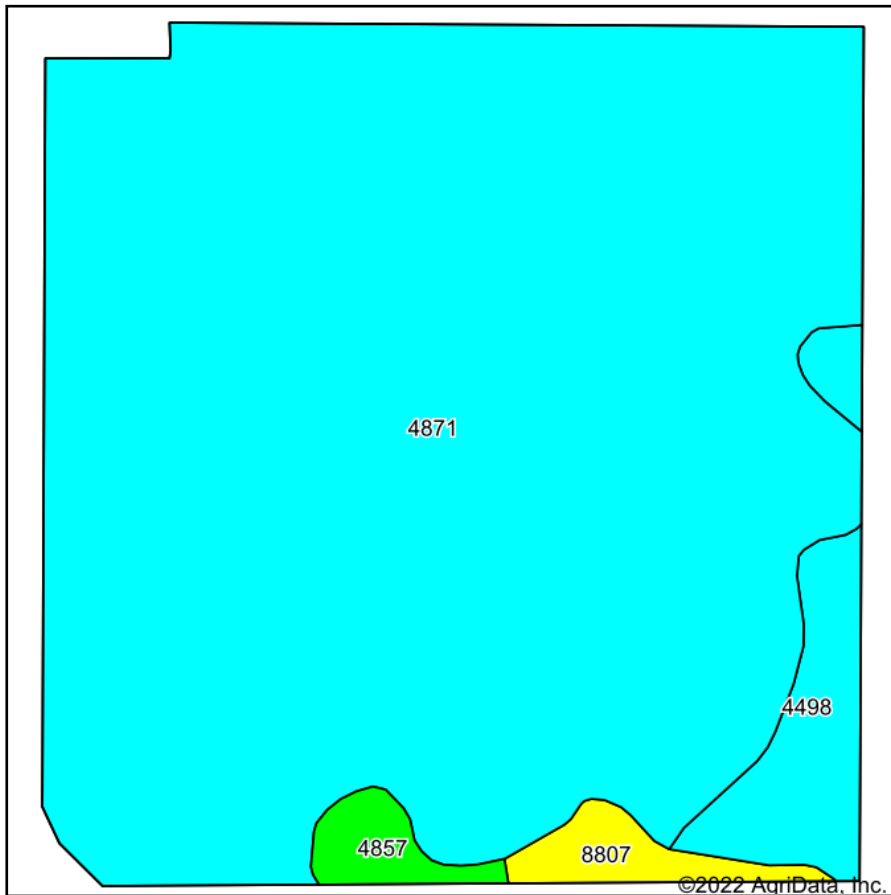

Soils data provided by USDA and NRCS.

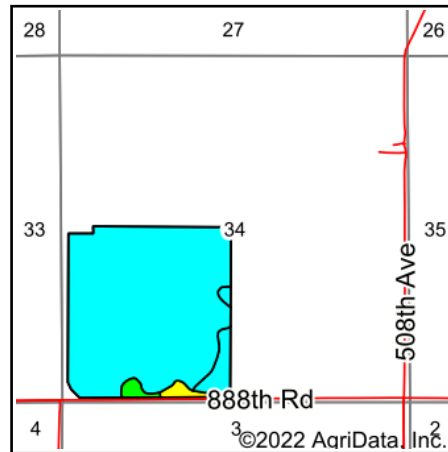

State: **Nebraska**
 County: **Holt**
 Location: **34-32N-9W**
 Township: **Steel Creek**
 Acres: **148.41**
 Date: **5/17/2022**



Area Symbol: NE089, Soil Area Version: 20

Code	Soil Description	Acres	Percent of field	Non-Irr Class Legend	Non-Irr Class *c	Irr Class *c	SRPG	Alfalfa hay Tons	Alfalfa hay Irrigated Tons	Corn Bu	Corn Irrigated Bu	Winter wheat Bu	*n NCCPI Soybeans
4871	Valentine-Dunday loamy fine sands, 0 to 3 percent slopes	135.79	91.5%		IVe	IVe	29	1	2			61	26
4498	Dunday loamy sand, 0 to 3 percent slopes	7.67	5.2%		IVe	IIIe	32	2	5	37	134	25	29
8807	Anselmo-O'Neill sandy loams, 0 to 3 percent slopes	2.71	1.8%		Ile	Ile	45	2	5	40	140	25	33
4857	Valentine-Dunday loamy fine sands, moist, 3-9 percent slopes	2.24	1.5%		Vle	IVe	28	1	2	1	65		26
Weighted Average					3.99	3.91	29.4	1.1	2.2	2.7	66.3	1.7	*n 26.3

*n: The aggregation method is "Weighted Average using all components"

*c: Using Capabilities Class Dominant Condition Aggregation Method

Soils data provided by USDA and NRCS.