

Soils Map

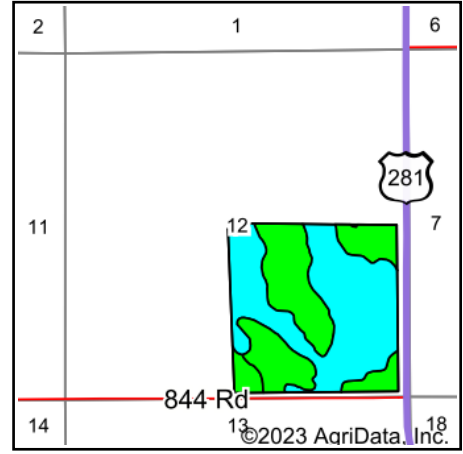

State: **Nebraska**
 County: **Wheeler**
 Location: **12-24N-12W**
 Township: **Clearwater**
 Acres: **146.42**
 Date: **12/1/2023**

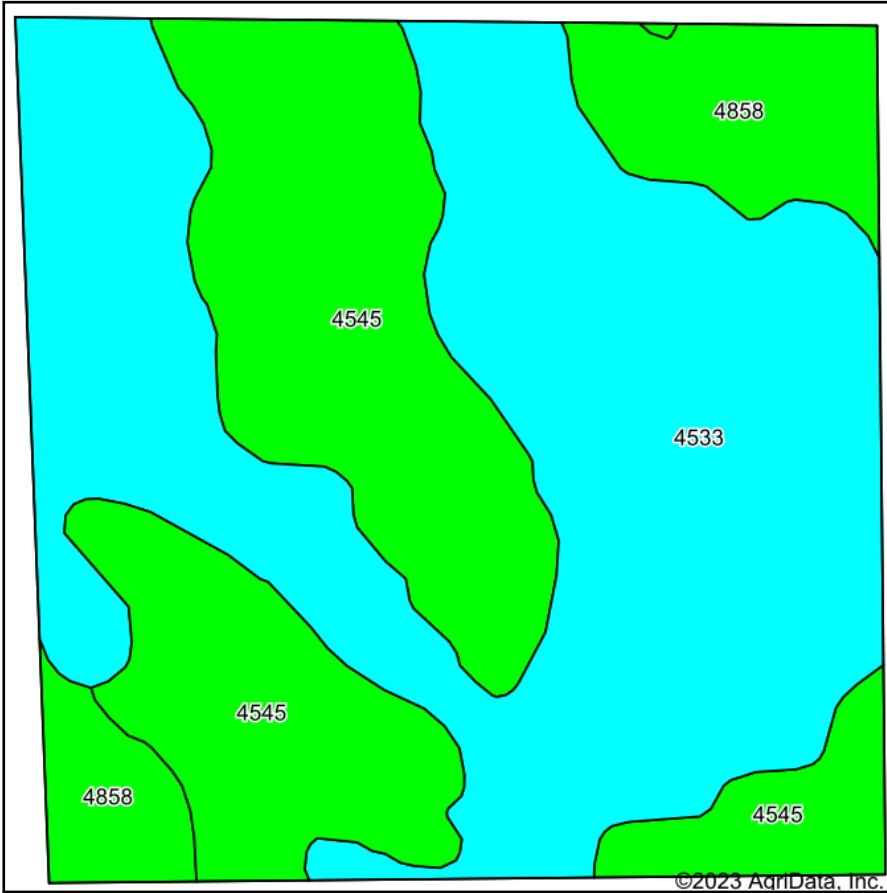

Maps Provided By:



© AgriData, Inc. 2023

www.AgriDataInc.com



Area Symbol: NE183, Soil Area Version: 21

Code	Soil Description	Acres	Percent of field	Non-Irr Class Legend	Non-Irr Class *c	Irr Class *c	SRPG	Alfalfa hay Irrigated Tons	Alfalfa hay Tons	Corn Irrigated Bu	Grain sorghum Irrigated Bu	*n NCCPI Overall	*n NCCPI Corn	*n NCCPI Soybeans
4533	Els loamy sand, 0 to 3 percent slopes	80.84	55.2%		IVw		27					29	17	18
4545	Els-lpage fine sands, 0 to 3 percent slopes	50.66	34.6%		VIw	IVw	25	2		51	39	25	18	18
4858	Valentine-Els complex, moist, 0 to 9 percent slopes	14.92	10.2%		VIe	IVe		3	1	80	20	28	26	20
Weighted Average					4.90	*-	23.6	1	0.1	25.8	15.5	*n 27.5	*n 18.3	*n 18.2

*n: The aggregation method is "Weighted Average using all components"

*c: Using Capabilities Class Dominant Condition Aggregation Method

*- Irr Class weighted average cannot be calculated on the current soils data due to missing data.

Soils data provided by USDA and NRCS.